

# BD Eclipse™ Blood Collection Needle

with BD Pronto™ Quick Release Holder

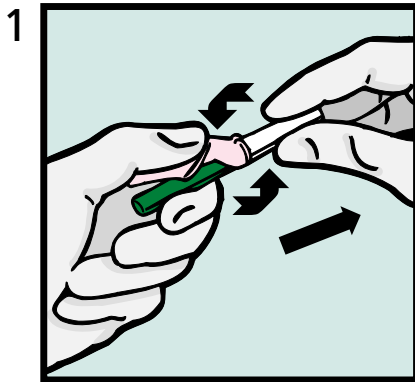

- Holding both colored shields, twist and remove white shield

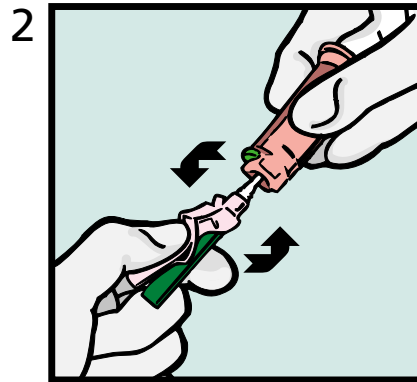

- Screw on the BD™ Pronto Holder

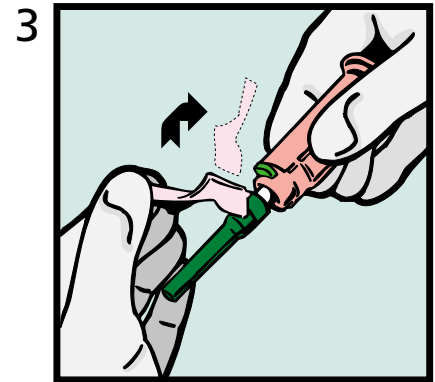

- Rotate safety shield back

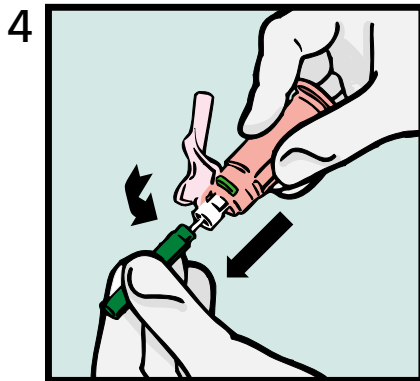

- Twist and pull needle shield straight off

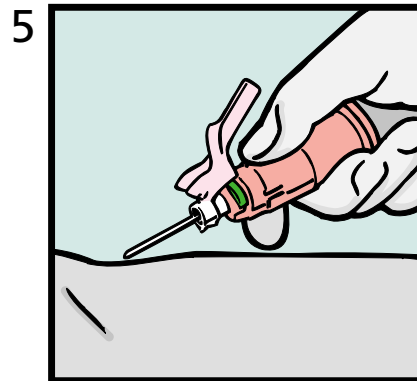

- Perform venipuncture

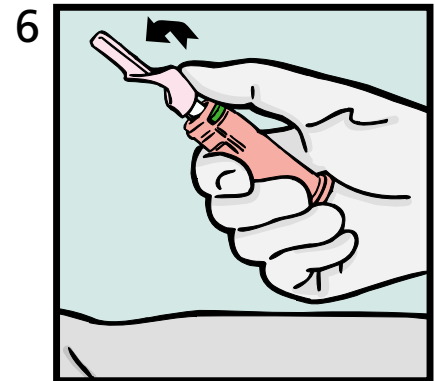

- Firmly push forward on the safety shield, lock into place and inspect

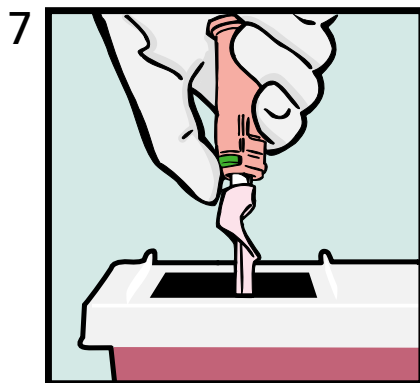

- Place the needle over the opening of the sharps container and push the green button of the holder to release the needle into the container

## Things to Remember:

- Handle all biologic samples and blood collection sharps (lancets, needles, luer adapters and blood collection sets) according to the policies and procedures of your facility
- Obtain appropriate medical attention in the event of any exposure to biologic samples (for example, through a puncture injury) since they may transmit viral hepatitis, HIV (AIDS) or other infectious diseases
- Utilize any built-in needle protector if the blood collection device provides one
- Discard BD Brand Eclipse Blood Collection Needle in the nearest sharps collector. Follow your institution's policy for safe disposal of all medical waste



**BD Vacutainer Systems**  
**Prenalytical Solutions**  
1 Becton Drive  
Franklin Lakes, NJ 07417

Technical Services:  
800.631.0174

[www.bd.com](http://www.bd.com)