

BD Vacutainer® Passive Shielding Blood Collection Needle

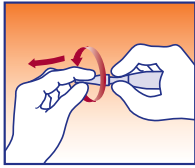

1. Twist and pull needle shield straight off.

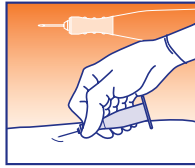

2. Perform venipuncture according to your facility's established procedures. Hold device securely.

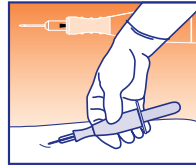

3. Insert tube. 1st tube releases safety shield to gently rest on patient.

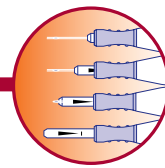

Safety shield is free to move over the needle.

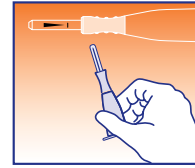

4. Remove needle from patient and safety shield will move forward to fully cover needle. Visually confirm complete shielding.



5. Discard entire assembly into an approved sharps disposal container.

Ordering Information				
368636	Passive Shielding Blood Collection Needle	21 G x 1 in. needle	25/Box 200/Case	
368637	Passive Shielding Blood Collection Needle	22 G x 1 in. needle	25/Box 200/Case	

Standard Safety Offering

Ordering Information			
Ref. #	Description		Packaging
BD Vacutainer® Eclipse™ Blood Collection Needle with Pre-Attached Holder			
368650	With Pre-Attached Holder, 21 G x 1 ¼ in.		100/Case
368651	With Pre-Attached Holder, 22 G x 1 ¼ in.		100/Case
BD Vacutainer® Eclipse™ Blood Collection Needle			
368607	21 G x 1 ¼ in.		48/Box 480/Case
368608	22 G x 1 ¼ in.		48/Box 480/Case

BD Vacutainer® Push Button Blood Collection Sets with Pre-Attached Holder					
Ref. #	Needle Gauge	Wing Color	Tubing Length	Configuration	Packaging
367352	21		12"	with holder	20/Box 100/Case
368656	23		12"	with holder	20/Box 100/Case
BD Vacutainer® Push Button Blood Collection Sets					
367338	21		7"	with luer	50/Box 200/Case
367344	21		12"	with luer	50/Box 200/Case
367326	21		12"	without luer	50/Box 200/Case
367336	23		7"	with luer	50/Box 200/Case
367342	23		12"	with luer	50/Box 200/Case
367324	23		12"	without luer	50/Box 200/Case
367341	25		12"	with luer	50/Box 200/Case
367323	25		12"	without luer	50/Box 200/Case
BD Vacutainer® One Use Holder					
Ref. #	Description		Packaging		
364815	One Use Holder		250/Bag 1,000/Case		

A Part of the BD Vacutainer® System of Venous Collection Products



CAUTION: Handle all biologic samples and blood collection "sharps" (lancets, needles, luer adapters, and blood collection sets) in accordance with the policies and procedures of your facility. Obtain appropriate medical attention in the event of any exposure to biologic samples (e.g., through a puncture injury) since samples may transmit viral hepatitis, HIV (AIDS), or other infectious diseases. Utilize any safety-engineered feature if the blood collection device provides one. Discard all blood collection "sharps" in biohazard containers approved for their disposal.

BD Global Technical Services: 1.800.631.0174
vacutainer_techservices@bd.com
BD Customer Service: 1.888.237.2762
www.bd.com/vacutainer



BD Diagnostics
 Preanalytical Systems
 1 Becton Drive
 Franklin Lakes, NJ 07417

A New Generation of Safety



Helping all people
live healthy lives

**BD Vacutainer®
Passive Shielding
Blood Collection Needle**



From BD, the leader in safety-engineered technology

The BD Vacutainer® Passive Shielding Blood Collection Needle is designed to provide the highest amount of protection against needlesticks during a blood draw. The needle's safety shield releases automatically upon insertion of the first tube, providing protection from the time the first tube is inserted through product disposal.

- The insertion of the first tube for blood draw automatically activates the floating safety shield
- No extra steps are required by the healthcare worker to activate the safety shield
- The safety shield covers the needle immediately upon withdrawal from patient, even if the needle is withdrawn due to sudden or unexpected patient movement
- 100% utilization of safety feature means users cannot bypass or circumvent safety feature, ensuring compliance
- Ideal for environments where patient cooperation is not assured

Perform venipuncture...



First tube releases safety shield



*User-friendly for
phlebotomists and nurses*

**Integrated, multi-sample needle
and holder — no assembly or
disassembly required**



*Flat side of holder allows
shallow angle of entry*

**Ergonomically designed
holder, with finger grips
that allow for a
catheter-like insertion**

**Safety shield indicator arrow helps to
judge needle depth during venipuncture**

**Bevel-up orientation
with indicator arrow**

**View the product
demonstration video!
Please visit
www.bd.com/vacutainer**

Safety shield advances as needle is withdrawn



Safety shield locks over needle



A New Generation of Safety