

# Uniject Activation and Use

1

Open the foil pouch and remove the Uniject .™

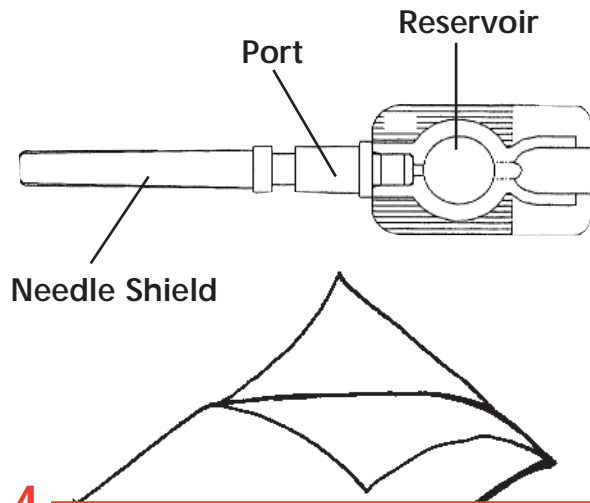

4

Remove the needle shield.

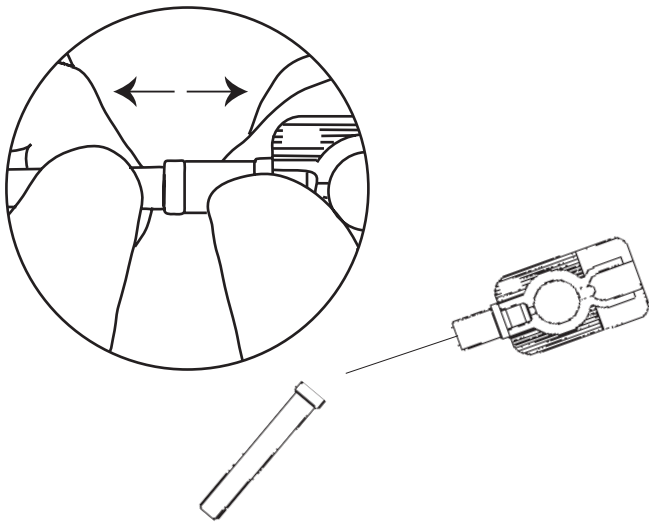

2

Hold the Uniject .™ by the port with your forefinger and thumb.

With a firm, rapid motion, push the needle shield into the port.

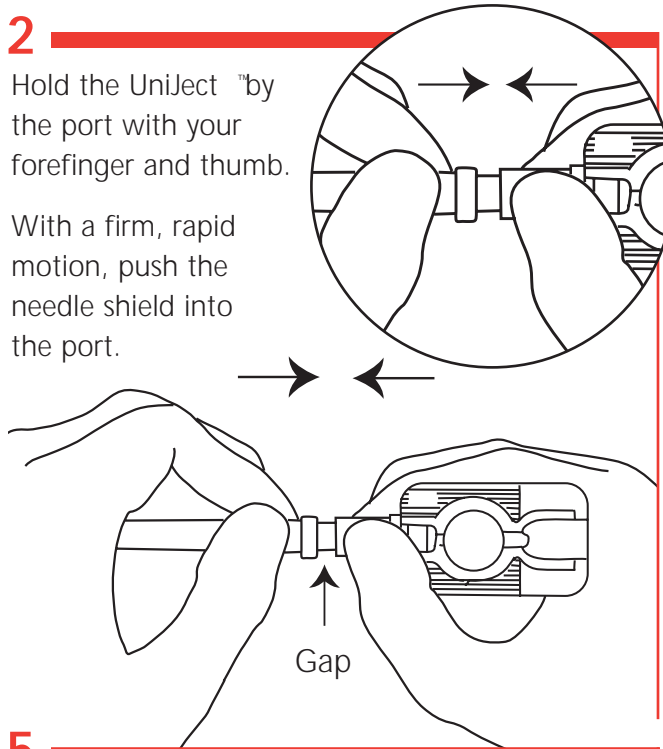

5

Continue to hold the Uniject .™ by the port and insert the needle into the patient.

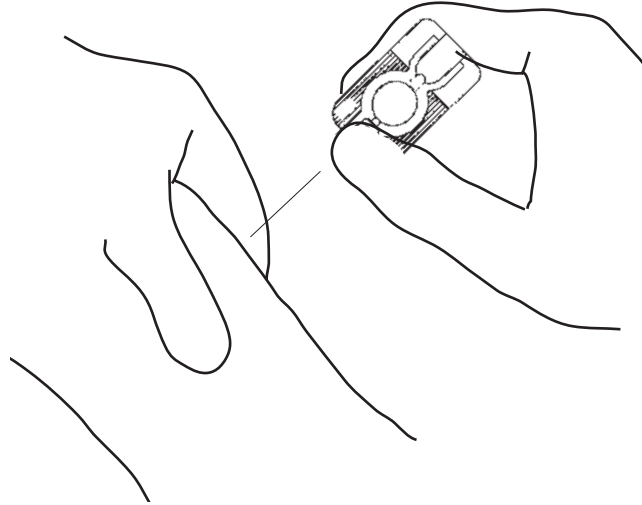

3

As Uniject .™ activates, you will feel a click. Continue to push firmly until you close the gap between the needle shield and port.

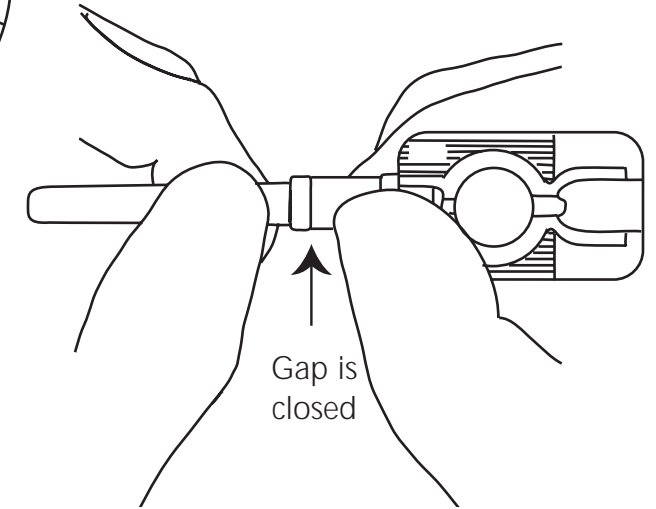

6

Squeeze the reservoir firmly to inject. After the reservoir completely collapses, remove the Uniject .™ Do not re-shield used Uniject .™

Discard the used Uniject .™ according to established medical waste disposal procedures.

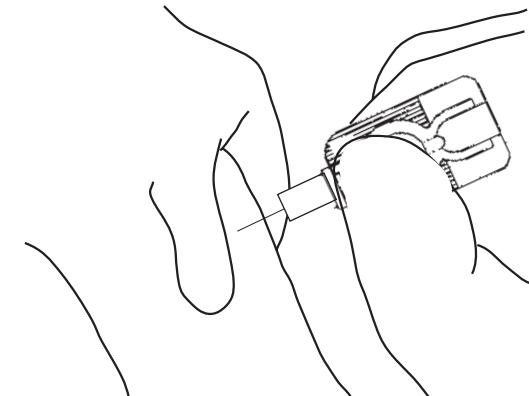

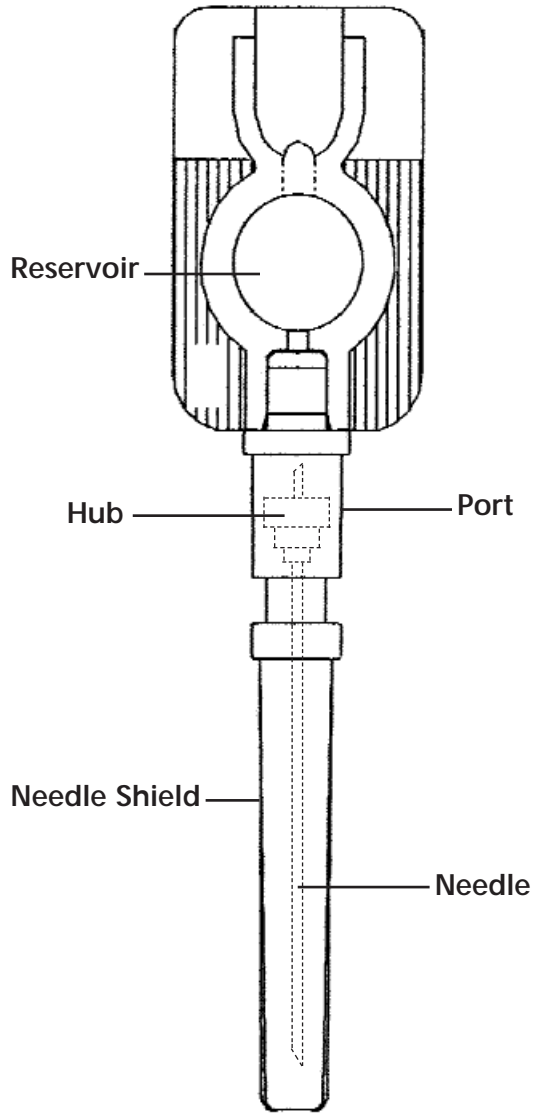

BD Pharmaceutical Systems  
Franklin Lakes, NJ, 07417



**BD Uniject™**

Prefill Injection Device

## *Activation and Use*

