

# BD GeneOhm™ MRSA

## Test Procedure

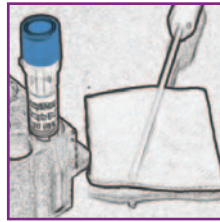
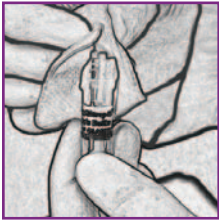

### 1 Specimen Preparation

- Place swab in sample buffer tube (blue cap)
- Break swab
- Vortex at high speed

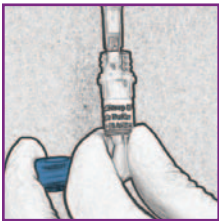

A

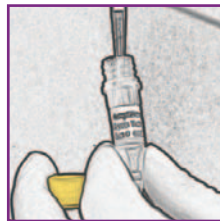

B

### 2 Concentration

- Transfer cell suspension (blue cap) to a lysis tube (yellow cap) (A-B)
- Centrifuge at a minimum of 14,000 x g at room temperature (C)
- Discard supernatant
- Add sample buffer (blue cap) to the lysis tube (yellow cap) (D)



C

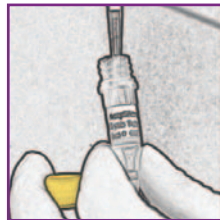

D

### 3 Lysis – DNA Extraction

- Vortex, centrifuge briefly, then heat to inactivate potential inhibitors
- Place lysis tube on a cooling block

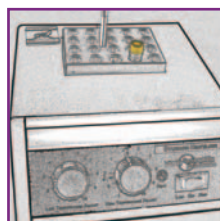
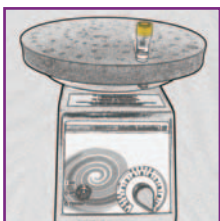

# BD GeneOhm™ MRSA

## Test Procedure

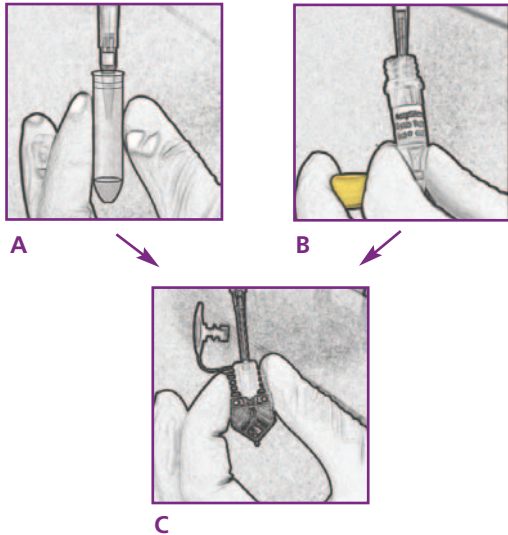

### 4 Reconstitution of Molecular Reagents

- Reconstitute 1 master mix (white label) for up to 6 specimens and 2 controls
  - Add diluent to lyophilized master mix (A) and transfer master mix to the reservoir of each reaction tube (C)
  - Transfer lysate solution (B) to the specimen reaction tube (C)
  - Add control DNA to positive control tube
  - Add sample buffer (blue cap) to negative control tube
  - Centrifuge all tubes briefly
  - Place tubes on specially adapted cooling block until ready to load

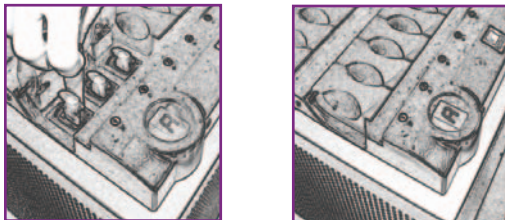

### 5 Real-Time PCR Analysis

- Insert each reaction tube into the instrument
- Start run and obtain results in approximately 1 hour

**Full Process Run Time < 2 hours**

### Definitive Test Results

- No interpretation required
- Internal control monitors inhibition

#### Assay Performance

- Sensitivity: 93%
- Specificity: 96%
- Negative Predictive Value: 98%
- Positive Predictive Value: 85%

The screenshot shows the GeneOhm software interface with a 'Results Table' containing 15 rows of data. The table includes columns for Site ID, Sample ID, Assay Result, IC Result, Warning/Error Code, Sample Type, Notes, and FAM Result.

Site ID	Sample ID	Assay Result	IC Result	Warning/Error Code	Sample Type	Notes	FAM Result
A1	98670	POS	NA		SPEC		NA
A2	23444	NEG	PASS		SPEC		NA
A3	57945	NEG	PASS		SPEC		NA
A4	82455	NEG	PASS		SPEC		NA
A5	19244	NEG	PASS		SPEC		NA
A6	20295	NEG	PASS		SPEC		NA
A7	54630	POS	NA		SPEC		NA
A8	67832	POS	NA		SPEC		NA
A9	90231	NEG	PASS		SPEC		NA
A10	76940	NEG	PASS		SPEC		NA
A11	23008	NEG	PASS		SPEC		NA
A12	45671	NEG	PASS		SPEC		NA
A13	87399	NEG	PASS		SPEC		NA
A14	Pos Cntrl1	Valid	NA		PC 1		Valid
A15	Neg Cntrl1	Valid	PASS		NC 1		Valid



**BD Diagnostics**  
6146 Nancy Ridge Drive  
San Diego, California 92121  
[www.geneohm.com](http://www.geneohm.com)  
888-GENE OHM

**BD Canada**  
2771 Bristol Circle  
Oakville, ON  
L6H 6R5  
800-268-5430

**Not for Lab Use • See package insert for test protocol.**

BD, BD logo and all other trademarks are property of Becton Dickinson and Company.  
Copyright © 2006 BD  
Patent protection pending